



**Infinity Buildings**

**Engineered for  
Higher-Quality Installation**





“Every great dream begins with dreamer. Always remember you have within you the strength, the patience and the passion to reach for the stars to change the world.”

At first I would like to convey my regards to all our esteemed customers for choosing H&H MECH TECH Pvt. Ltd.

We have a long journey since our establishment in year 2007 to become one of leading PEB manufacturers in India.

This has been possible only by the support and wishes of our esteemed customers and dedication of team H&H. We hope to build this trust and relationship



## MILESTONE

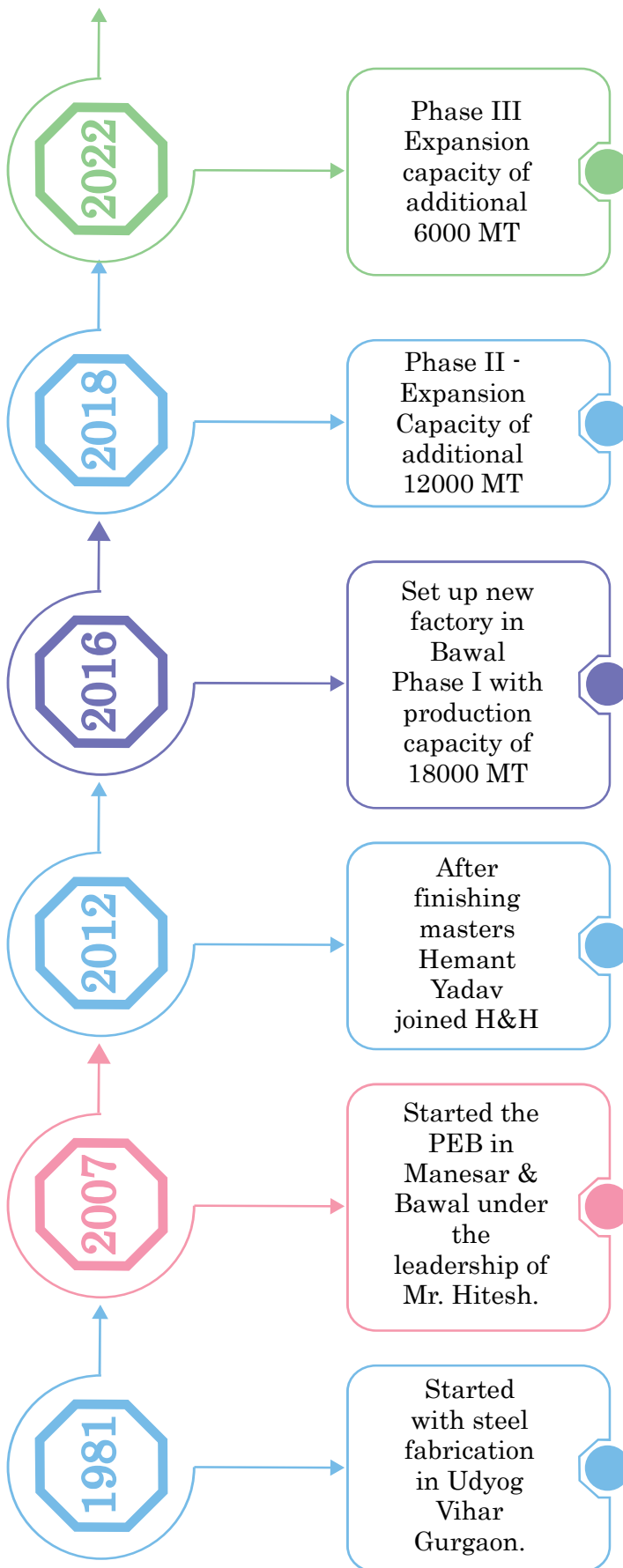



# Welcome to the preferred partner for industrial buildings

## WHO WE ARE

H&H is a renowned & one of the leading players in PEB industry – having manufacturing capacity of 36,000 MT per annum.

In the year 2007, the company started its journey as Pre Engineered Building manufacturer with a unit in Bawal Haryana.

In due course the company through successive expansions in capacities as well as product line, witnessed a explosive growth to become the most preferred partner for the construction of Pre Engineered building across the India.



Over the years, H&H has created an unblemished reputation by establishing unrivalled quality, flexibility & reliability in all its products and service offerings: central to this achievement being the company's drive to exceed customer's expectations.

Present Machine Lines: CNC Plasma , Shearing Machine (6.3mx20mm), H Beam Line, Saw Welding Line, H Beam Straightening Line, Mig Welding, Roll Forming (Standing Seam, High Rib Profiling, Z&C Roll Forming), Shearing & Bending, Chaser, PTW line, Decking Roll Forming line.

## PLANT & MACHINERY

---



CNC PLASMA CUTTING



SHEARING MACHINE



C&Z ROLL FORMING LINE



H-BEAM LINE & WELDING LINE



HIGH RIB ROLL FORMING LINE



H-BEAM STRAIGHTENER

## BUILDING COMPONENTS



### ◀ HIGH RIB

Cover Width: 1080 mm

Thicknesses: 26 / 24 gauge

Standard Colors: H&H standard colours

### DECKING ▶

Cover Width: 960 mm

Thicknesses: 0.8 - 1.25 mm

Standard Colours: Pre-galvanized

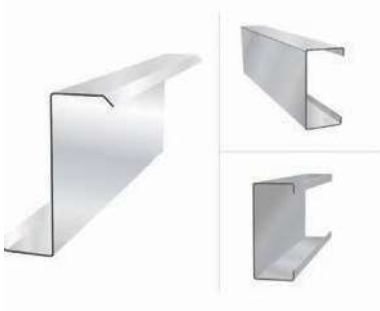

### ◀ COLD FORMED SECTIONS

Profile: C & Z Sections

Thicknesses: 1.5 - 3.0 mm

Standard Finish: Pre-galvanized  
120 / 275 gsm.

## Building Types Primary Farming System

At H & H, practically any type of geometric frame can be built. Some of the most commonly used primary framing systems are featured here...

### Clear Span

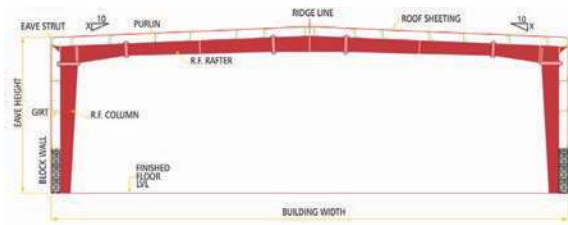

### ■ Intermediate Column - 1

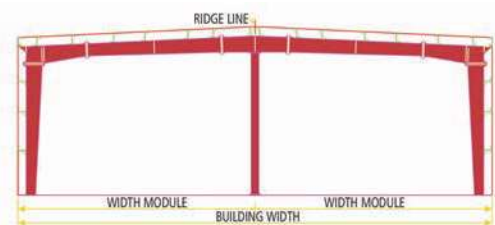

### Multi Gable - 2



### ■ T - Canopy



### ■ L - Canopy

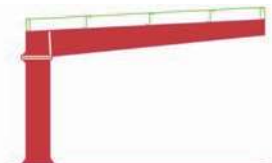



## H&H FACTORY PREMISES

---





# Welcome to the preferred partner for industrial buildings

## Unmatched Design & Engineering Capability

A strong in-house engineering team offers technical support that includes optimized design & detailing, through internationally acclaimed software's. From design to erection our team of professionals ensures an architect's vision into reality.



## State-of-art Manufacturing

The brand's product superiority is well complemented by its manufacturing expertise. World class manufacturing facility strategically located at Bawal Haryana ensures on time product delivery with consistency in quality

## Customer Centric Solutions

H&H provides customer centric solutions with a wide product basket for diverse applications. Our on time delivery promise is well augmented by multi-locational installation teams and sales network.

With a focus on customer's success, we offer value added services like construction, engineering & preventive maintenance support.





# BUILDING ADDITIONS

## Fascia

### Cantilevered Fascia

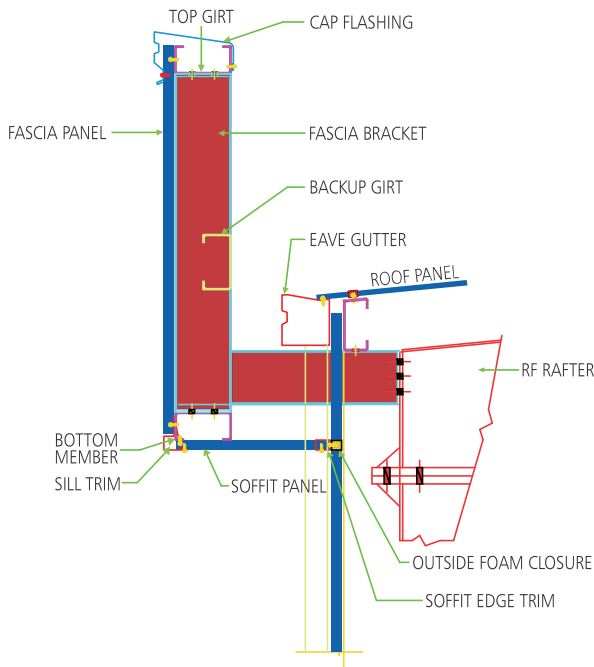

### Cantilevered Fascia with Curved top & bottom

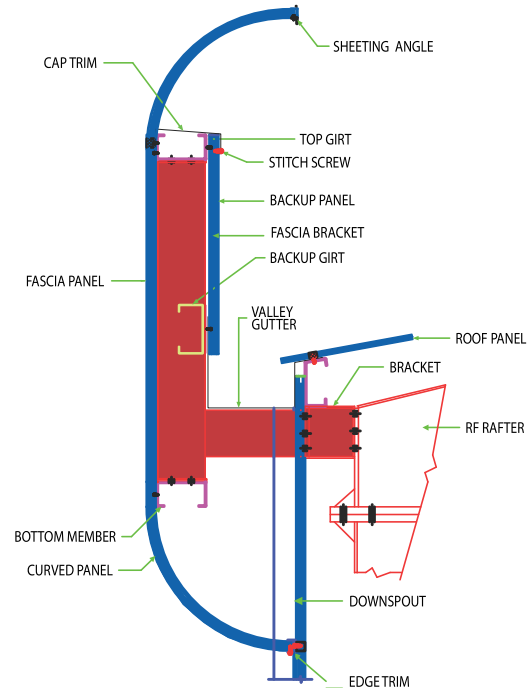

## Canopies

H & H Mechtech standard canopies are 2.0 M wide and can be provided at eave or any height below the eave. If required, Soffit panels can also be provided. Rafters for canopies are made from hot rolled or built-up I sections.

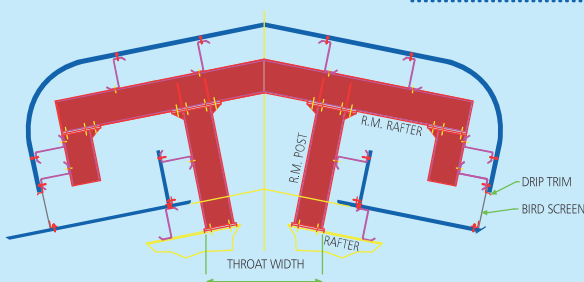
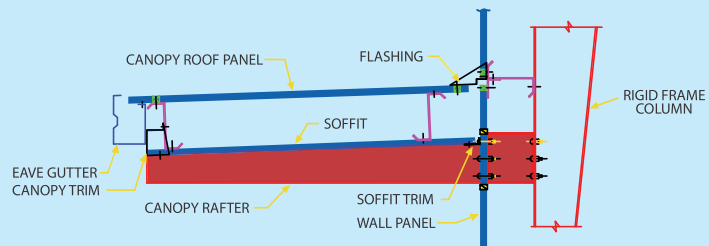

## Roof Monitor

H & H Mechtech standard roof monitor has a throat width of 1.5 M and a height of 1.0 M, made from hot rolled sections. Panels for roof monitor will be the same as supplied for the main building unless otherwise specified. We can also supply roof monitor of varied sizes as per clients' requirements.

## Crane Systems

H & H designs buildings to support various crane systems, such as EOT, Monorail, Under Hung, Jib etc. Overhead cranes of up to 25MT are generally supported with brackets. For capacities more than 25 MT, a stepped column/independent support system is provided. For H & H to provide the best and the most economical solution, the following crane data need to be assessed...

- Location of crane with travel length
- Centre to centre distance of crane rails
- Crane hook height
- Wheel loads
- Vertical and horizontal clearances
- Wheel base and bumper distances
- Type of crane operations
- No. of cranes operating in a single bay

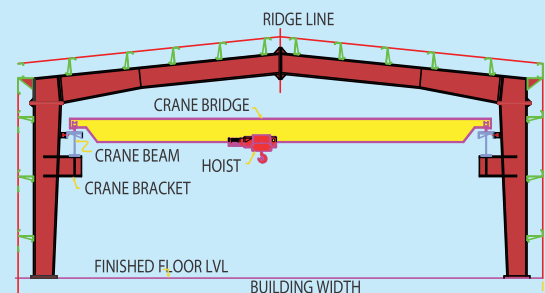

In case the above data is not furnished by the client, standard Electromech Crane Data is used upon client's approval.

## BUILDING ACCESSORIES

### ■ Louvers

H & H Mechtech's standard louvers are 2.0 M long X 0.60 M wide in size. Non-standard sizes can also be provided on request.

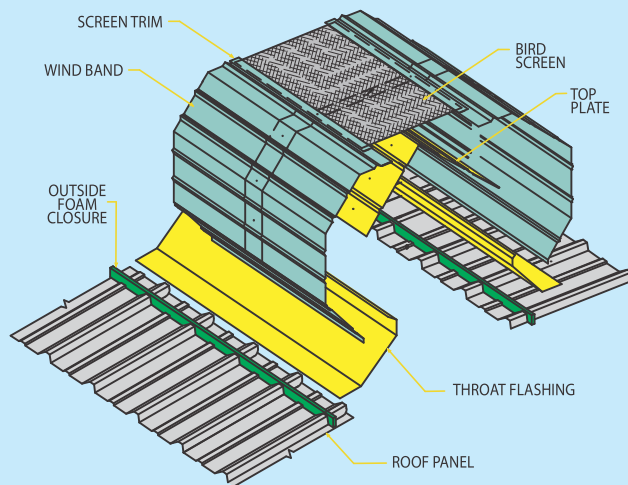
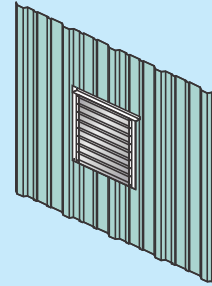

### ■ Ridge Ventilators

H&H Mechtech's standard ridge ventilators are of 0.3 M throat width and can be supplied either continuous or in modules of 3.0 M length.

## ROOF MONITOR RIDGE VENTILATOR

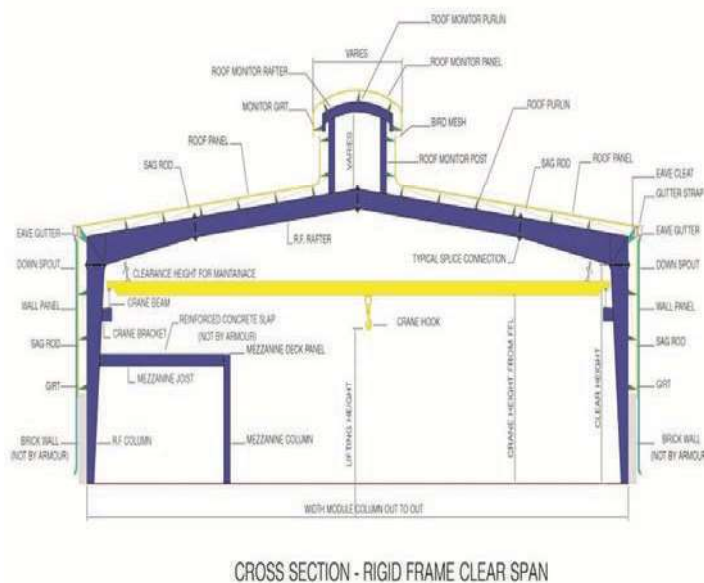



## H&H SSR

Double-lok 360° 10 Year 100 % Leak Proof Warranty

### TECHNICAL SPECIFICATIONS:

- Consists of 610mm wide roll formed panels with a 65 mm high corrugation
- The panel is fixed with a clip allowing linear and lateral expansion and contraction
- The flat side of the panel contains cross flutes improving the panel rigidity under foot traffic
- The panels are produced in 0.55mm nominal thickness Aluzinc coated high tensile strength steel



### ACCESSORIES

In order to maintain the water tightness integrity and aesthetic appearance, a full range of accessories adapted to SS roof systems have been developed:

- Skylights
- Ventilators
- Polycarbonate vaults
- Water gutter
- Flashings



SS Clamp

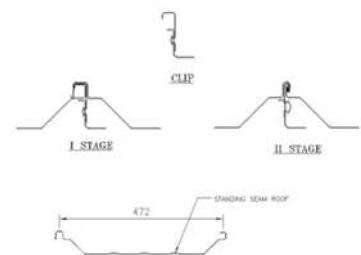
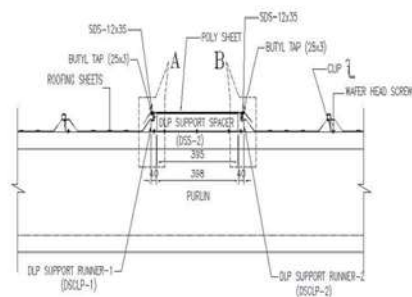
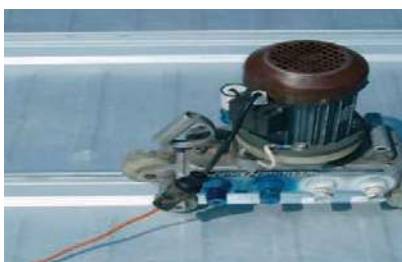

### ADVANTAGES OF SSR

- The clip allows free expansion and contraction, thus avoiding any stress in the roof system
- Long-lasting, ultimate moisture tightness
- Side lap formed on site with a special seaming machine, crimping a 360° double-lock seam
- The panel is connected to the secondary structure with a special clip and roll formed on its top into the seam
- Once seamed the entire roof forms a monolithic metal membrane
- Thermal bridges reduced to spacing clips

## Suneel Auto Components (6500 Sqm, 400 MT)



## Alfatherm (7000 Sqm, 450 MT)





## Amazon, Gurugram (15000 Sqm, 750 MT)



## TYPICAL PRE-ENGINEERED STEEL BUILDING

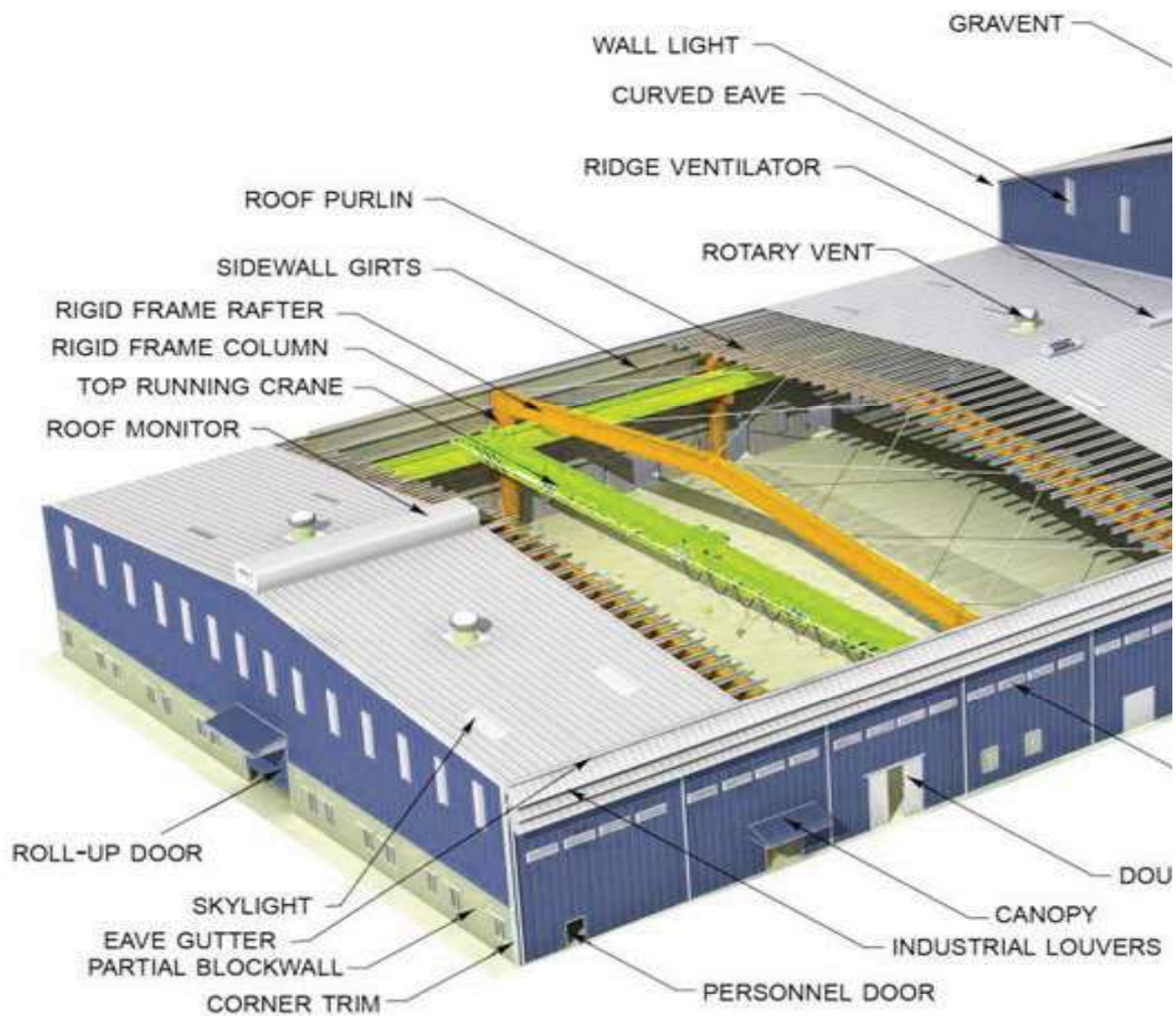



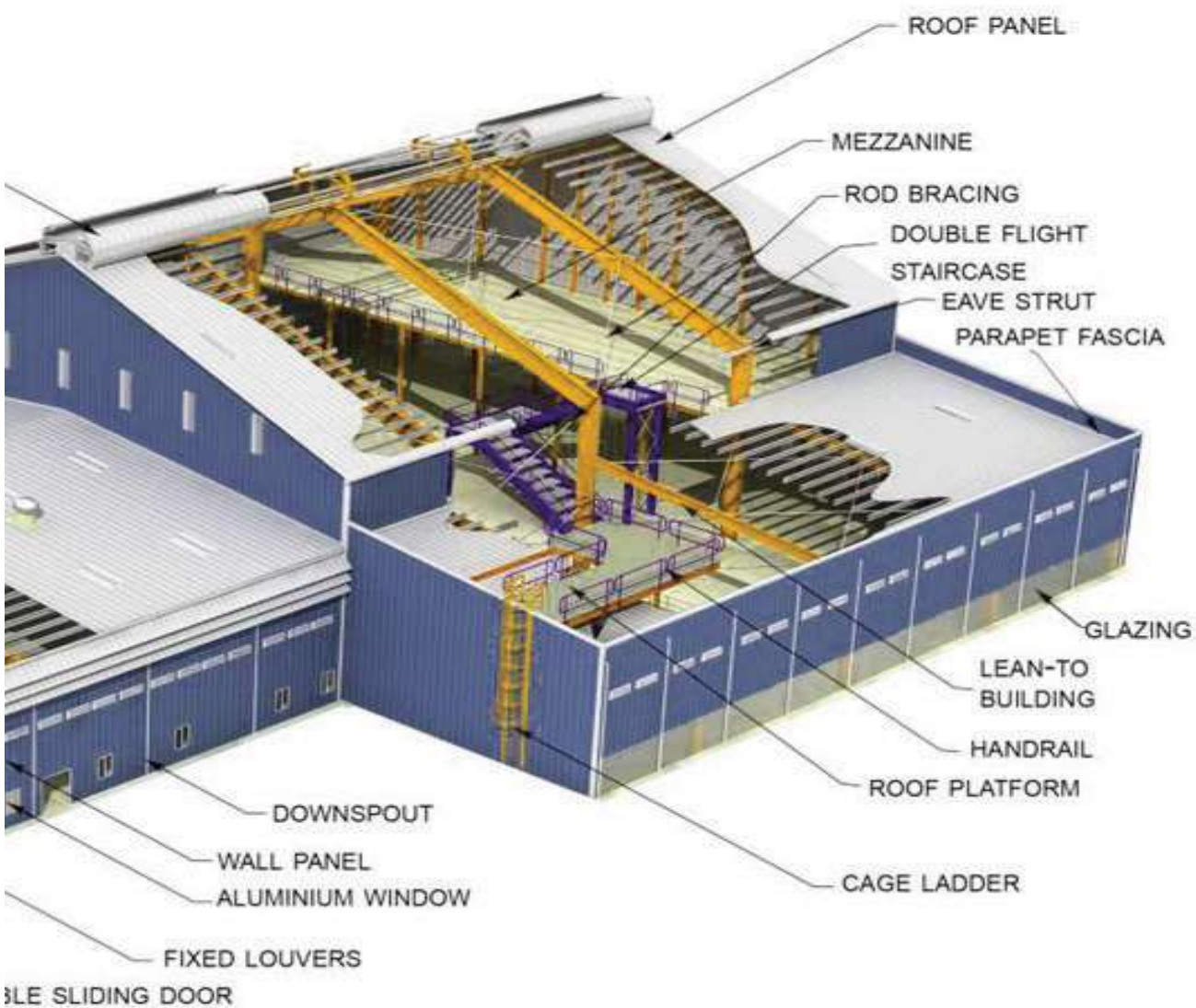

## Flipkart Delhi (75000 Sqm, 3150 MT)





## Shree Ram Raghav Spinning Mill (50000 Sqm, 2800 MT)





## ALP Polymer Park (4 Buildings, 1550 MT)



## Ultima Mesa Neemrana (35000 Sqm)



## Helious Gas (Ghiloth, 5500 Sqm)



## Micromax Bhiwadi (35000 Sqm)





## Sachdeva Polycolor MET Jhajjar (6000 Sqm)



## Jindal Aluminium Bhiwadi (2850 MT)





## Repin Masterbatches Bhiwadi (G+2 Building)



## DH Lighting Neemrana (G+2 Building, 310MT)



## SRNB Warehouse Dahruhera (8000 Sqm, 550 MT)





## Royal Plasto Craft (Ghiloth 1178 MT)





## OUR PROJECTS



Bosch Chassis System India Limited.  
(IMT, Manesar)



Birla Cement Dadri, Guatam Budh Nagar



Sandhar Roloforms (IMT, Manesar)



Nippon Leakless Talbros Pvt Ltd. (Bawal)



Daikin Air-Conditioners (Neemrana)



Flash Forge (VIZAG)



Hyco Gears (Bawal)



Roop Polymers (IMT, Manesar)



Amazon Manesar



Mani Mahesh Metal (IMT, Manesar)

## OUR PROJECTS



Bosch Chassis System India Ltd. (Uttaranchal)



Rahul Wire Ropes (Bhiwadi)



Lafarge Boral Gypsum Plant (Khushkhera)



Rohtang Tunnel Project – (Manali)



Tulips Baghpat



Rajshayama constructions



Safex Chemicals Keshwana



## OUR PROJECTS



Aravalli Warehouse Raliawas



NTF Gujarat



Uniproducts Gujarat



Ess Kay Fabrication



Indolink Technologies Greater Noida



Meghatech International Bilaspur



NTF India Manesar



Rajmann Overseas



ICT Mumbai

## OUR VALUED CUSTOMERS







**H & H Mechtech Pvt. Ltd.**  
Steel grip with promise

**Pre Engineered Buildings & Structures**  
Construct future with Innovation

Visit us at : [www.handhmechtech.com](http://www.handhmechtech.com)  
Email: [hnhpeb2022@gmail.com](mailto:hnhpeb2022@gmail.com), [hemant@handhmechtech.com](mailto:hemant@handhmechtech.com)

Khasra No. 77//14/1, Village Tankari Road Opp. Govt. ITI School Tankari Bawal, Distt; Rewari (HARYANA) 123412  
Visit us at [www.handhmechtech.com](http://www.handhmechtech.com) Mail id: [admin@handhmechtech.com](mailto:admin@handhmechtech.com), [hnhpeb2022@gmail.com](mailto:hnhpeb2022@gmail.com)  
Phone no. : 01284-267777  
M: +91-9212344442, +91-9810799070